

Outhouse Plans

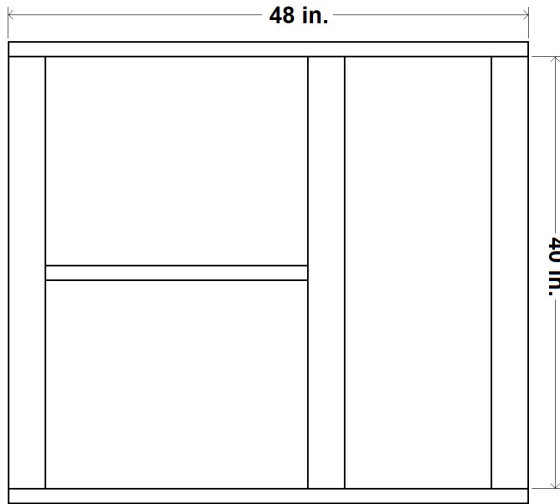

- Outhouse foundation frame is made from:
- one 10 ft. treated 4x4 cut in thirds = 40 in.
 - one 8 ft treated 2x4 cut in half = 48 in.
 - another treated 2x4 in the middle of the floor

The spacing of the middle 4x4 depends on the width of the Seat Deck, which in turn, depends on the measurements of the Toilet Seat.

- Be sure to allow space for the bolts that hold the Toilet Seat to the Deck inside of the framing for the Deck
- The front edge of the Toilet Seat should almost come to the front edge of the Deck

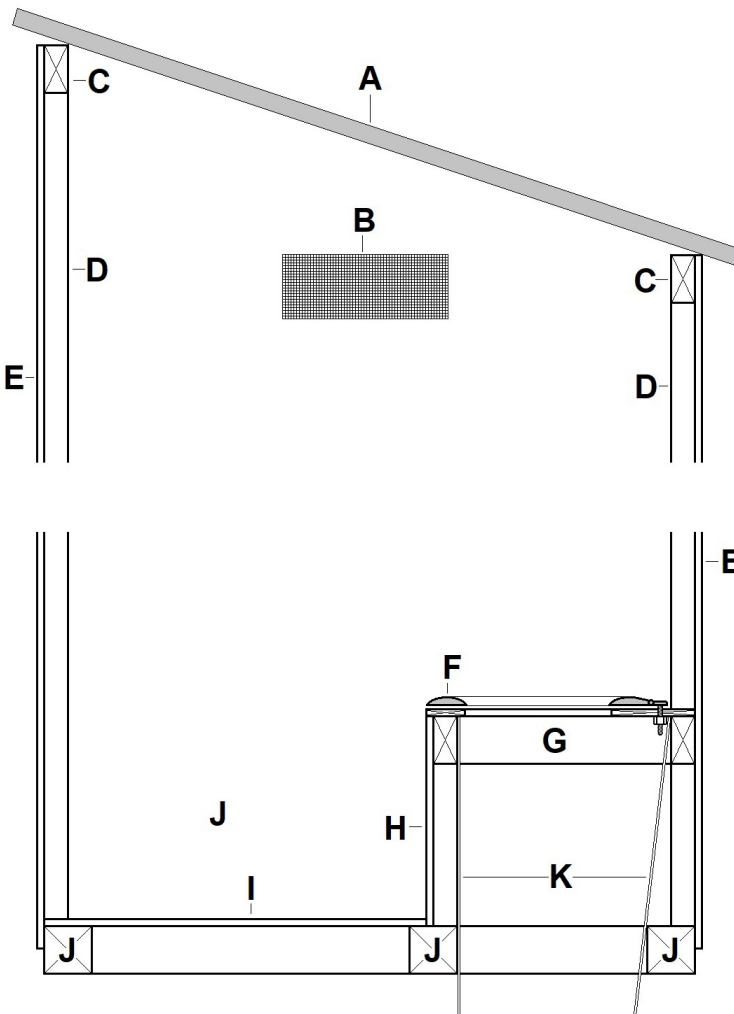

The 'hole' in the Deck should be slightly larger than the 'hole' in the Toilet Seat.

- A. Fiberglass Roofing —gives more interior light than metal roofing
- B. Soffit Vent —for ventilation
- C. 2X4 Header —for roofing support
- D. 2x2 bracing —in corners for Siding
- E. Siding
- F. Toilet Seat
- G. 2x4 frame —for Seat Deck
- H. Front cover for Seat Deck —could piece cut from back piece of siding to give roof slope
- I. Floor Deck
- J. 4x4 Foundation Frame —1 treated 10 ft. 4x4 cut in thirds = three 40 in. lengths
- K. Pieces of Sheet Metal —to deflect droppings into the hole, (to keep it from getting hung up in the framing), could be roofing 'tin'